

# KEOFITT SAMPLING BAG™ 1000 ml "Patent pending"

ART. NO. 151000

## GENERAL

- The KEOFITT Sampling Bag is the ideal sampling bag solution for any liquid food/dairy application. The unique design provides an effective sterilization/disinfection of the sample flow path to ensure the integrity of the sample. The bag can stand upright when filled.
- The KEOFITT Sampling bag is a single-use multi-layer sampling bag manufactured under clean room conditions (ISO class 8).
- The KEOFITT Sampling Bag is intended for collecting samples for microbiological, chemical and/or physical analysis.
- Designed for sampling of any liquids containing particles with a diameter of up to 15 mm.
- The KEOFITT Sampling Bag is a single-use product available in the following sizes: 1000 ml (#151000) - 2000 ml (#152000).



## FEATURES

- Compatible with all KEOFITT sampling valves by using one of these quick couplings for connection to the KEOFITT Sampling Bag inlet:
  - #150083 - Quick Coupling KSB Inlet f/hose piece
  - #150084 - Quick Coupling KSB Inlet 3/4" clamp
  - #150085 - Quick Coupling KSB Inlet 1" clamp
  - #150088 - Quick Coupling KSB Inlet 1/2" clamp
- Inlet: white / Outlet: blue  
- both protected by a peel-off aluminum foil seal.

- Quick couplings for KEOFITT Sampling Bag outlet:
  - #150082 - Quick Coupling KSB Outlet 3/8" hose barb (closeable)
  - #150086 - Quick Coupling KSB Outlet Non-Return-Valve
- Caps for KEOFITT Sampling Bag inlet and outlet:
  - #150061 - Quick Coupling KSB Outlet st. steel plug
  - #150062 - Quick Coupling KSB Inlet st. steel plug

## CERTIFICATION\*

EU EC 1935/2004 · EU EC 2023/2006 · EU EC 10/2011

## TECHNICAL DATA

### Material

Bag: Polypropylene (OPA 15 / 100 PP)  
Inlet / Outlet: Polypropylene (Purell HP671T)  
O-ring: Silicone, red (#150820, #150859)

### Pressure & Temperature

Process pressure: Depending on sampling valve. Avoid overfilling the bag.  
Product temperature: Up to 80°C / 176°F  
CIP pressure: Max. 5 bar / 72 psi  
SIP temperature: 121°C / 249°F (recommended)

### Net weight

Kg/lbs: 0.022 kg/0.049 lbs

## STORAGE AND SHELF LIFE

The KEOFITT Sampling Bag should be stored in dry storage areas between 15-25 °C, 40-70% humidity and should always be kept out of direct sunlight and away from any source of artificial ultraviolet light. Store in dry and dust free areas in the original packing for as long as possible.  
Shelf life: 3 years from production.



\*For further information and downloads please visit [www.keofitt.dk](http://www.keofitt.dk)



# Fittings for the KEOFITT SAMPLING BAG™

## INLET

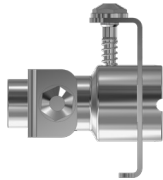

#150083  
QUICK COUPLING KSB INLET  
FOR HOSE PIECE



#150084  
QUICK COUPLING KSB INLET  
3/4" CLAMP



#150085  
QUICK COUPLING KSB INLET  
1" CLAMP

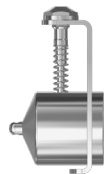

#150062  
QUICK COUPLING KSB INLET  
STAINLESS STEEL PLUG



#150088  
QUICK COUPLING KSB INLET  
1/2" CLAMP

## OUTLET

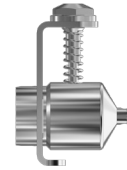

#150061  
QUICK COUPLING KSB OUTLET  
STAINLESS STEEL PLUG



#150082  
QUICK COUPLING KSB OUTLET  
3/8" HOSE BARB (CLOSABLE)

