





# VALVE HEAD M4 TYPE H



ART. NO. 400041

## GENERAL

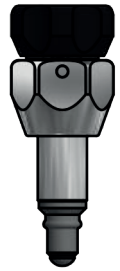
-  The KEOFITT CLASSIC M4 Sampling Valve is the smallest KEOFITT sampling valve. Used in all industries for decades. More than 120 standard valve configurations. Unique serial no. for each valve\*.
-  The sampling valve can be used for any process sampling for microbiological, chemical and/or physical analysis.
-  **Cleaning/sterilizing:** Between batches: Valve in open position: Cleanable by means of CIP using the detergent solution suitable for the actual process media. Between samples: Valve in its normal closed position: cleanable by CIP as “Between batches” or the valve may be sterilized by means of steam SIP or chemical SIP using a procedure appropriate to the actual circumstances. For further advice, please contact KEOFITT. Not recommended for autoclave due to plastic parts.
-  Designed for sampling of liquids with a viscosity of up to approx. 100 cP containing no particles larger than Ø1.5 mm. Sampling of more viscous liquids is possible, only will it take longer (depending on process pressure).



## FEATURES

-  Installation: Threaded socket connection M16x1
-  Membrane: Silicone (#400051)
-  Operation: Turn knob - spring loaded (opens clockwise).

## CERTIFICATION\*

- Valve head: EU EC 1935/2004 · EU EC 2023/2006 · DK No. 681 25/05/2020 · ATEX 2014/34/EU · PED 2014/68/EU · FDA CFR 21 §177.2600 · USP Class VI · KEOFITT DoC.
- Membrane: EU EC 1935/2004 · EU EC 2023/2006 · DK No. 681 25/05/2020 · FDA CFR 21 §177.2600 · USP Class VI · REACH · RoHS · ADI Free · KEOFITT DoC.

## TECHNICAL DATA

### Material (process contact)

Membrane: Silicone, grey (#400051)

### Material (without process contact)

Steel parts: AISI 303 (1.4305) / AISI 316L (1.4404)  
Turn knob: PA6 (black) / PTFE

### Pressure & Temperature

Pressure: 0 - 10 bar / 0 - 145 psi  
Temperature: 1 - 130°C / 34 - 266°F  
Air supply: -

### Net weight

Kg/lbs: 0.099 kg / 0.218 lbs

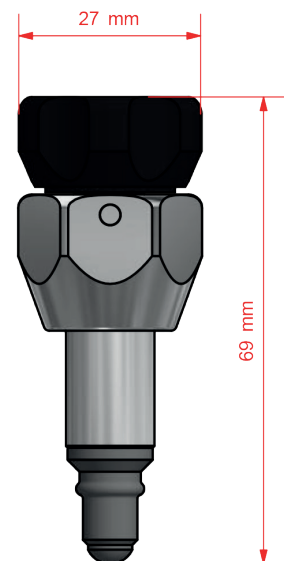

## SPARE PARTS

#774041 Parts for M4 head 400041/42/43/47



\*For further information and downloads please visit [www.keofitt.dk](http://www.keofitt.dk)