





VALVE HEAD 4KAI TYPE N PTFE



ART. NO. 445544

GENERAL

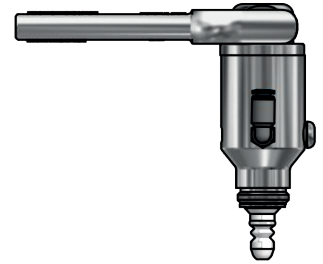
-  The KEOFITT 4KAI Sampling Valve is our low cost sterilizable sampling valve for less demanding applications. Replaces non-hygienic sampling cocks. More than 20 different configurations available.
-  The sampling valve can be used for any process sampling for microbiological, chemical and/or physical analysis.
-  **Cleaning/sterilizing:** Between batches: Valve in open position: Cleanable by means of CIP using the detergent solution suitable for the actual process media. Between samples: Valve in its normal closed position: cleanable by CIP as “Between batches” or the valve may be sterilized by means of steam SIP or chemical SIP using a procedure appropriate to the actual circumstances. For further advice, please contact KEOFITT. Autoclavable.
-  Designed for sampling of liquids with a viscosity of up to approx. 100 cP containing no particles larger than Ø1.5 mm. Sampling of more viscous liquids is possible, only will it take longer (depending on process pressure).



FEATURES

-  Installation: Threaded socket connection M18x1.5
-  Membrane: PTFE, white (#400055)
-  Operation: Pneumatically operated / Lever handle (#600170)
Spring closed - when not pressurized.

CERTIFICATION*

- Valve head: EU EC 1935/2004 · EU EC 2023/2006 · DK No 681 25/05/20 · 3-A Certificate · ATEX 2014/34/EU · PED 2014/68/EU · FDA CFR 21 §177.2600 · USP Class VI · Keofitt DoC.
- Membrane: EU EC 1935/2004 · EU EC 2023/2006 · DK No 681 25/05/20 · FDA CFR 21 §177.2600 · USP Class VI · ADI Free · Keofitt DoC.

TECHNICAL DATA

Material (process contact)

Membrane: PTFE, white (#400055)

Material (without process contact)

Steel parts: AISI 304 (1.4307)
Lever handle: AISI 316L (1.4404)

Pressure & Temperature

Pressure: 0 - 6 bar / 0 - 87 psi
Temperature: 1 - 130°C / 34 - 266°F
Air supply: 5 - 7 bar / 73 - 102 psi

Net weight

Kg/lbs: 0.352 kg / 0.776 lbs

SPARE PARTS

774444PTFE Parts for 4KAI/Basix head N PTFE

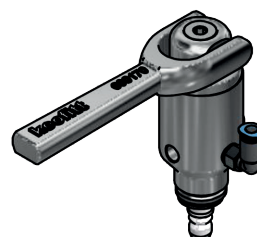
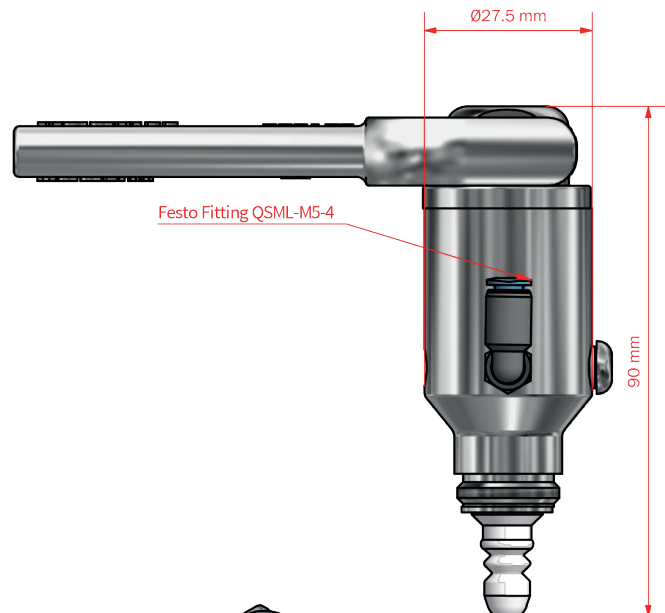

*For further information and downloads please visit www.keofitt.dk