





# VALVE BODY W9 MINI TRI-CLAMP



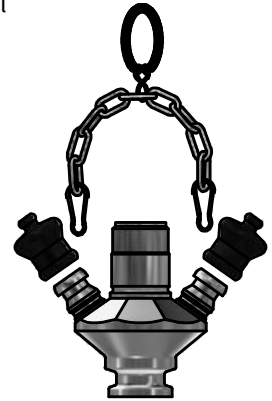

ART. NO. 850036

## GENERAL

-  The KEOFITT CLASSIC W9 Sampling Valve is the original and leading sterilizable sampling valve in the world. Used in all industries for decades. More than 320 standard valve configurations. Unique serial no. for each valve\*.
-  The sampling valve can be used for any process sampling for microbiological, chemical and/or physical analysis.
-  **Cleaning/sterilizing:** Between batches: Valve in open position: Cleanable by means of CIP using the detergent solution suitable for the actual process media. Between samples: Valve in its normal closed position: cleanable by CIP as "Between batches" or the valve may be sterilized by means of steam SIP or chemical SIP using a procedure appropriate to the actual circumstances. For further advice, please contact Keofitt.
-  Designed for sampling of liquids with a viscosity of up to approx. 1.000 cP containing no particles larger than Ø3 mm. Sampling of more viscous liquids is possible, only will it take longer (depending on process pressure).



## FEATURES

-  Installation: 1/2" Clamp DIN 32676:2009-05 Table 4 Row C
-  Operation: Depending on choice of valve head
-  Inlet / Outlet: Hose piece
-  Membrane: Depending on choice of valve head

## CERTIFICATION\*

· EU EC 1935/2004 · EU EC 2023/2006 · DK No 681 25/05/2020 · 3-A Certificate · 3.1 Material Certificate · Ra Certificate  
· ATEX 2014/34/EU · PED 2014/68/EU · Keofitt DoC

## TECHNICAL DATA

### Material (process contact)

- Steel parts                      AISI 316L (1.4404)

### Material (without process contact)

- Steel parts                      AISI 316L (1.4404)
- Rubber cap                      EPDM (black)
- Stainless steel chain            AISI 316L (1.4404)

### Surface Treatment

- Outside                          Electropolished Ra ≤ 1.2 µm
- Inside (wetted surface)        Electropolished Ra ≤ 0.5 µm
- Process connection            Electropolished Ra ≤ 0.5 µm

### Pressure & Temperature

- Pressure                          Depending on choice of valve head
- Temperature                      Depending on choice of valve head
- Air supply                          Depending on choice of valve head

### Net Weight

- kg/lbs                              0.308 kg/0.679 lbs

### Spareparts

- 778501                              PARTS FOR W9 850001/03/11/14/21/27/28/36

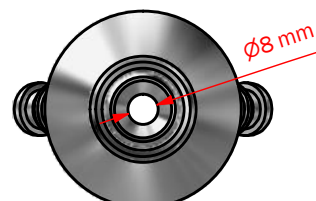
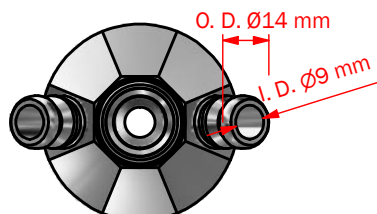
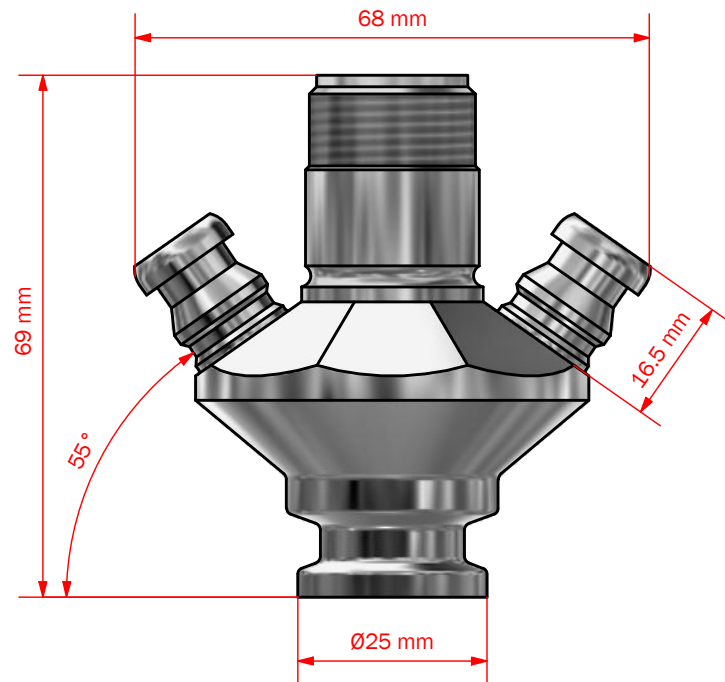

\*For further information and download please visit [www.keofitt.dk](http://www.keofitt.dk)