





# VALVE BODY W15 C3"ASME/DIN 3/4" CLAMP



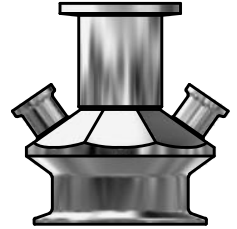

ART. NO. 860003

## GENERAL

-  The KEOFITT CLASSIC W15 Sampling Valve is designed for high viscosity sampling such as fruit pulp etc.. Design based on the original KEOFITT and based on one-piece-construction. Unique serial no. for each valve\*.
-  The sampling valve can be used for any process sampling for microbiological, chemical and/or physical analysis.
-  Cleaning/sterilizing: Between batches: Valve in open position: Cleanable by means of CIP using the detergent solution suitable for the actual process media. Between samples: Valve in its normal closed position: cleanable by CIP as "Between batches" or the valve may be sterilized by means of steam SIP or chemical SIP using a procedure appropriate to the actual circumstances. For further advice, please contact Keofitt.
-  Designed for sampling of liquids with a viscosity of up to approx. 50.000 cP containing no particles larger than Ø8 mm. Sampling of more viscous liquids is possible, only will it take longer (depending on process pressure).



## FEATURES

-  Installation: 3" Clamp DIN 32676:2009-05 Table 4 Row C, can be fitted for NA-connect acc. ASME BPE-2 / DIN
-  Operation: Depending on choice of valve head
-  Inlet / Outlet: 3/4" Clamp DIN 32676:2009-05 Table 4 Row C
-  Membrane: Depending on choice of valve head

## CERTIFICATION\*

· EU EC 1935/2004 · EU EC 2023/2006 · DK No 681 25/05/20 · 3.1 Material Certificate · Ra Certificate · ATEX 2014/34/EU · PED 2014/68/EU · Keofitt DoC

## TECHNICAL DATA

### Material (process contact)

- Steel parts                      AISI 316L (1.4404)

### Material (without process contact)

- Steel parts                      AISI 304 (1.4304)

### Surface Treatment

- Outside                              Electropolished Ra ≤ 1.2 µm
- Inside (wetted surface)        Electropolished Ra ≤ 0.5 µm
- Process connection            Electropolished Ra ≤ 0.5 µm

### Pressure & Temperature

- Pressure                            Depending on choice of valve head
- Temperature                      Depending on choice of valve head
- Air supply                          Depending on choice of valve head

### Net Weight

- kg/lbs                                2.354 kg/5.185 lbs

### Spareparts

- NOT APPLICABLE

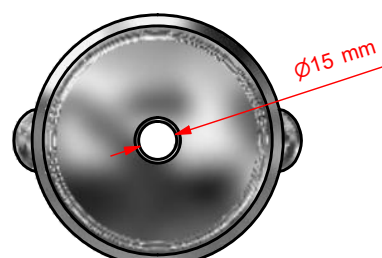
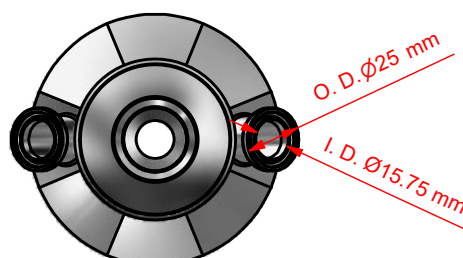
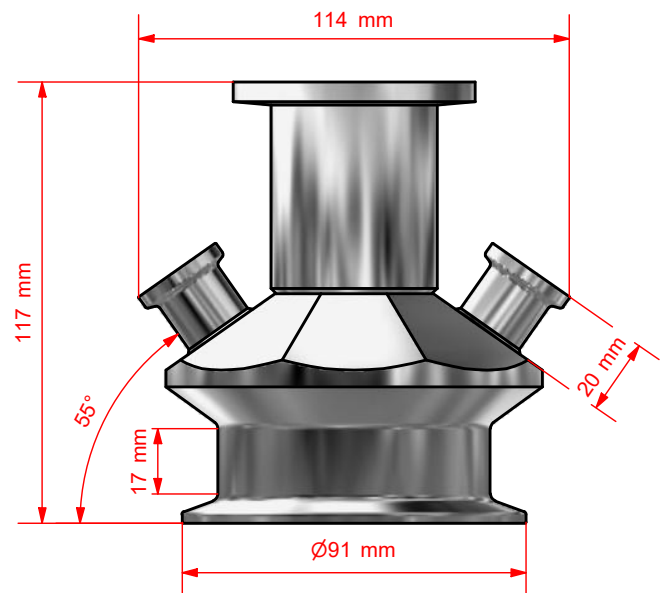

\*For further information and download please visit [www.keofitt.dk](http://www.keofitt.dk)