

BLIND CAP f/ 1/2" CLAMP

ART. NO. 900021

GENERAL



KEOFITT has the widest selection of spare parts and accessories to complete your sampling system.



Compatible to all KEOFIT sampling valves with W9 and Sesame 1/2" clamp inlet / outlet.



FEATURES



Connection: 1/2" clamp inlet / outlet



Outlet: Closure

CERTIFICATION*

- 3.1 Material Certificate

TECHNICAL DATA

Material (process contact)

-

Material (without process contact)

- Steel parts AISI 316L (1.4404)

Surface Treatment

- Outside -
- Inside -

Pressure & Temperature

- Pressure Depending on choice of valve head
- Temperature Depending on choice of valve head

Net Weight

- kg/lbs 0.019 kg/0.043 lbs

Spareparts

-

NOT APPLICABLE

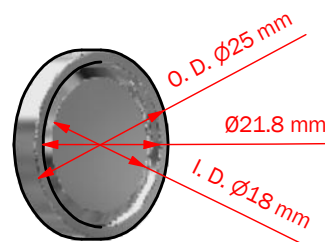
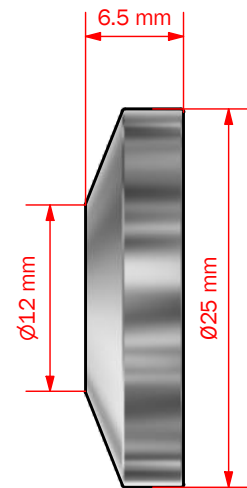

*For further information and download please visit www.keofitt.dk