

BLIND CAP f/ 1" CLAMP

ART. NO. 900076

GENERAL



KEOFITT has the widest selection of spare parts and accessories to complete your sampling system.



Compatible to all KEOFIT sampling valves with W25 1" clamp.



FEATURES



Connection: 1" clamp inlet / outlet



Outlet: Closure

CERTIFICATION*

- 3.1 Material Certificate

TECHNICAL DATA

Material (process contact)

-

Material (without process contact)

- Steel parts AISI 316L (1.4404)

Surface Treatment

- Outside -
- Inside -

Pressure & Temperature

- Pressure Depending on choice of valve head
- Temperature Depending on choice of valve head

Net Weight

- kg/lbs 0.079 kg/0.174 lbs

Spareparts

-

NOT APPLICABLE

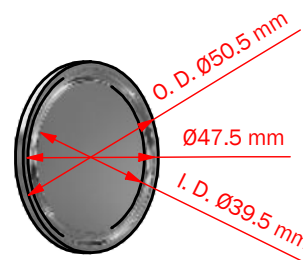
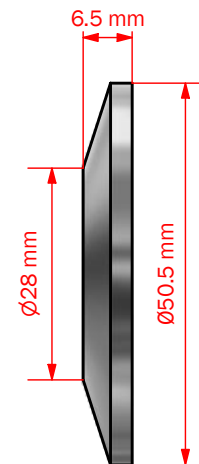

*For further information and download please visit www.keofitt.dk